

Jx = 004.700 cm4
 Jy = 004.700 cm4
 Sx = 002.580 cm3
 Sy = 002.580 cm3

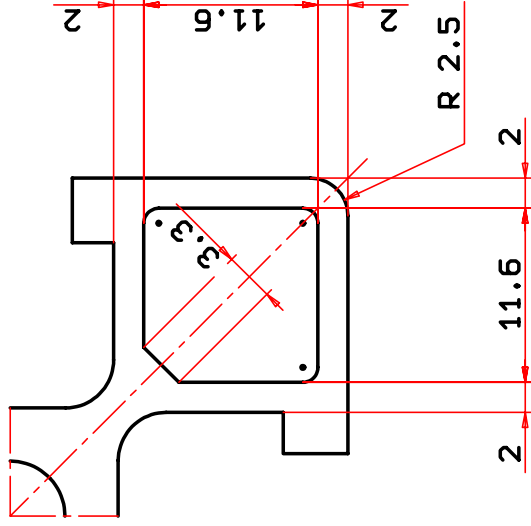

MODIFICHE

ACCOPIAMENTI

EURAL
 GNUTTI S.P.A.

COMPANY
 WITH QUALITY SYSTEM
 CERTIFIED BY DNV
 =ISO 9002=

EURAL GNUTTI S.P.A.
 Via S. Andrea, 3
 25038 ROVATO (BS)
 ITALY
 TELEPHONE
 +39.030.7725011
 FAX
 +39.030.7701228
<http://www.eural.com>
 e-mail: dies@ural.it

Spigoli con ● = R.1.0
 Spigoli non quotati = R.0.3
 Du/Smin= 22

sez. mm 495
 g./ml. 1338
 ø c. cir. 43
 tipo C-B

Data 23/11/98 scala 2/1:1
 Dis. M.R. Contr. *g/t*
 N° matricola
981136
 Lega
6060

TOLLERANZE GENERALI
DIN 17615