

Jx = 048.330 cm4
 Jy = 689.890 cm4
 Sx = 021.480 cm3
 Sy = 076.650 cm3

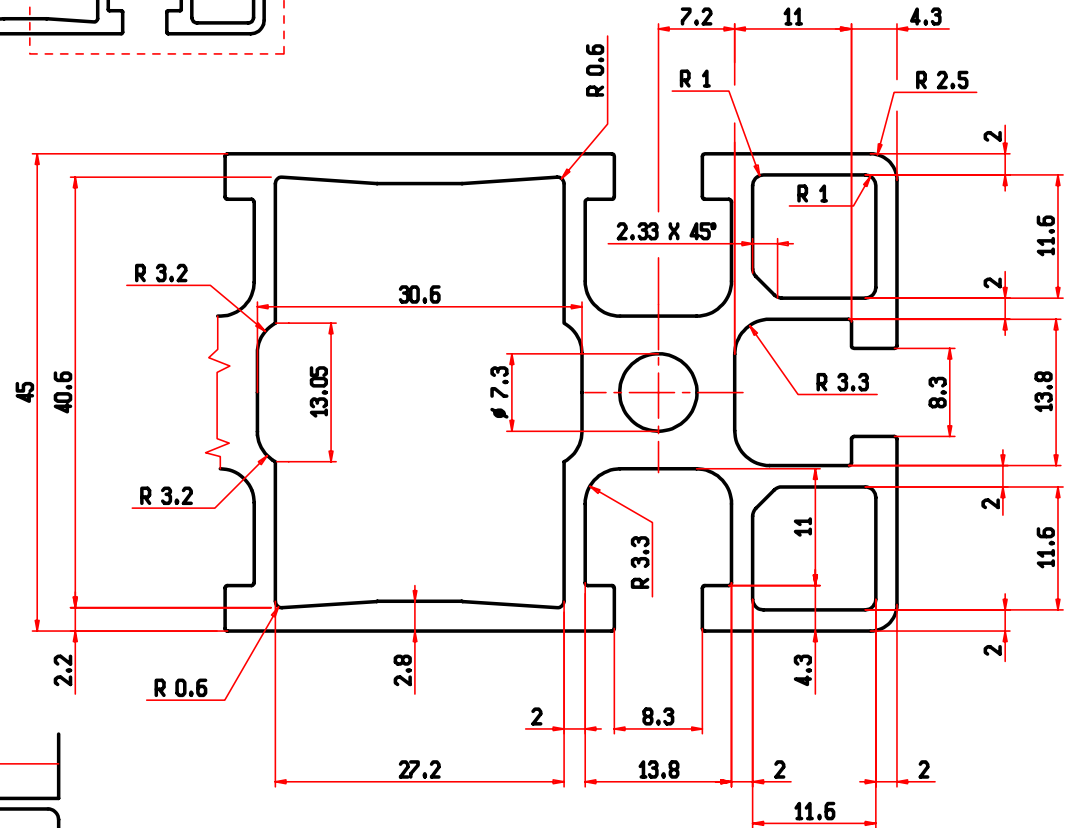

PART. "A"

SCALA 2:1

MODIFICHE

ACCOPPIAMENTI



GNUTTI S.p.A.

EURAL GNUTTI S.p.A.
 Via S. Andrea, 3
 25038 ROVATO (BS)
 ITALY
 TELEPHONE
 +39.030.7725011
 FAX
 +39.030.7701228
<http://www.eural.com>
 e-mail: dies@eural.it

COMPANY
 WITH QUALITY SYSTEM
 CERTIFIED BY DNV
 ISO 9002

Spigoli con ● = R ---
 Spigoli non quotati = R 0.25
 Du/Smin= 83

TOLLERANZE GENERALI
 DIN 1748

sez. mm 2206
 g./ml. 5958
 ø c. cir. 185
 tipo C-C

Data 10/01/01 scala 2/1:1
 Dis. M.R. Contr. *[Signature]*

N° matricola Lega
010103 6063