

Jx = 029.380 cm4  
 Jy = 016.720 cm4  
 Sx = 009.790 cm3  
 Sy = 007.430 cm3

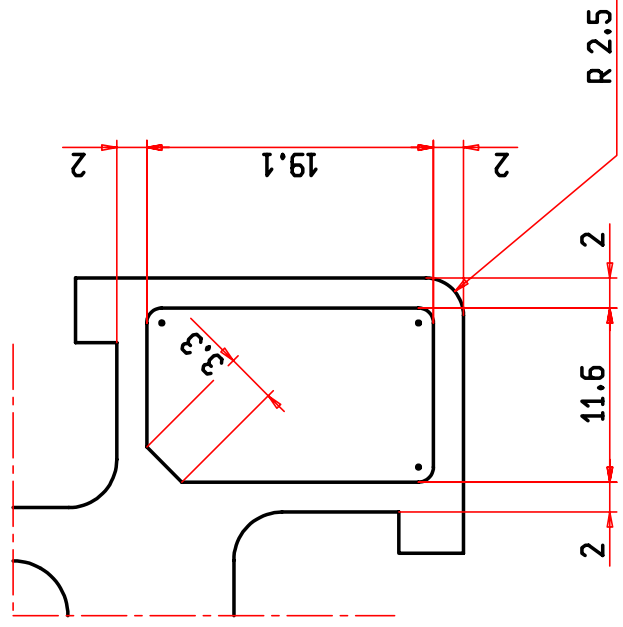

MODIFICHE

ACCOPPIAMENTI

**EURAL**  
 COMPANY  
 WITH QUALITY SYSTEM  
 CERTIFIED BY DNV  
 =ISO 9002=

**GNUTTI S.P.A.**  
 Via S. Andrea, 3  
 25038 ROVATO (BS)  
 ITALY  
 TELEPHONE +39.030.7725011  
 FAX +39.030.7701228  
 http://www.eural.com  
 e-mail:dies@ural.it

**EURAL GNUTTI S.P.A.**  
 Via S. Andrea, 3  
 25038 ROVATO (BS)  
 ITALY  
 TELEPHONE +39.030.7725011  
 FAX +39.030.7701228  
 http://www.eural.com  
 e-mail:dies@ural.it

Spigoli con ● = R.  
 Spigoli non quotati = R.0.3  
 Du/Smin=

sez. mm 1035  
 g./ml. 2805  
 ø c. cir. 73  
 tipo C-B

TOLLERANZE GENERALI  
**DIN 17615**

Data 26/03/99 scala 2/1:1  
 Dis. M.R. Contr. *g/tc*  
 N° matricola **990338**  
 Lega 6060